



1/F, Acme Building, 22-28 Nanking Street, Kowloon, Hong Kong

Tel: 2388 7171 Fax: 2710 8012

Email: acme@acmesanitary.com.hk

Website: www.acmesanitary.com.hk

PROJECT		REF		REV	ITEM CODE	
LOCATION		DATE			PAGE	

SANITARY WARE SPECIFICATION SHEET

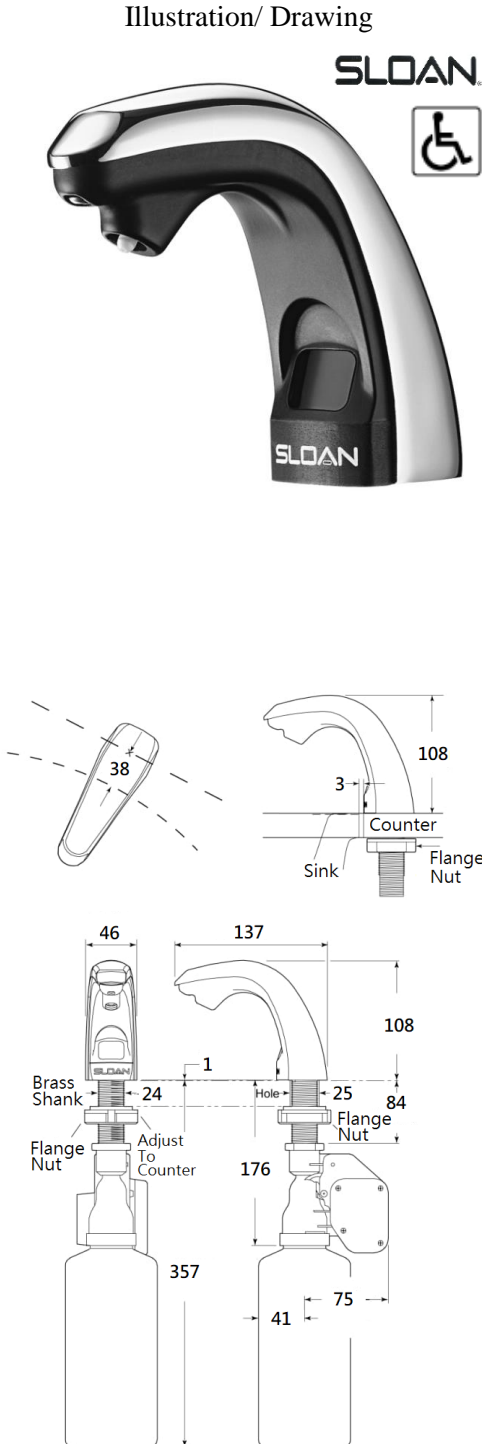
Item Descriptions	Sloan (USA) Sensor-operated deck mounted liquid soap dispenser DC supply	<div>Illustration/ Drawing</div> <div></div>
Dimensions	L137 x W46 x H108 mm	
Model	ESD-250-CP	
Code Number	3346050	
Finish	Polished Chrome	
Manufacturer	Sloan (USA)	
Supplier	Acme Sanitary Ware Co. Ltd Mr. Eric Wong/ Mr. Don Yuen	
Contact Tel/Fax	(852) 2388-7171 / (852) 2710-8012	
E-mail	acme@acmesanitary.com.hk	
Website	www.acmesanitary.com.hk	
<div>FEATURES</div> <div>Sensor Activated, Electronic, Chrome Plated Die Cast Body, Hand Washing Liquid Soap Dispenser with the following features:</div> <div><ul style="list-style-type: none">• Modular One-piece Construction and easily attaches to deck surface• Four (4) D-size Alkaline Batteries included• Low Battery Indicator• Low Soap Level Indicator• Black Plastic Throat Plate• All mounting hardware included• Easy Loading Disposable Soap Refills• New Pump and Delivery Tube with each Refill• Unit supplied with one 800 ml. Container of Lotion Soap</div>		
<div>SOAP REFILLS</div> <div><ul style="list-style-type: none">• ESD-217 (800mL)• ESD-232 (1600mL)• ESD-231 (800mL)• ESD-233 (1600mL)</div>		

Note:

** All information of the above is for the reference only. No prior notice is made if any changes.*

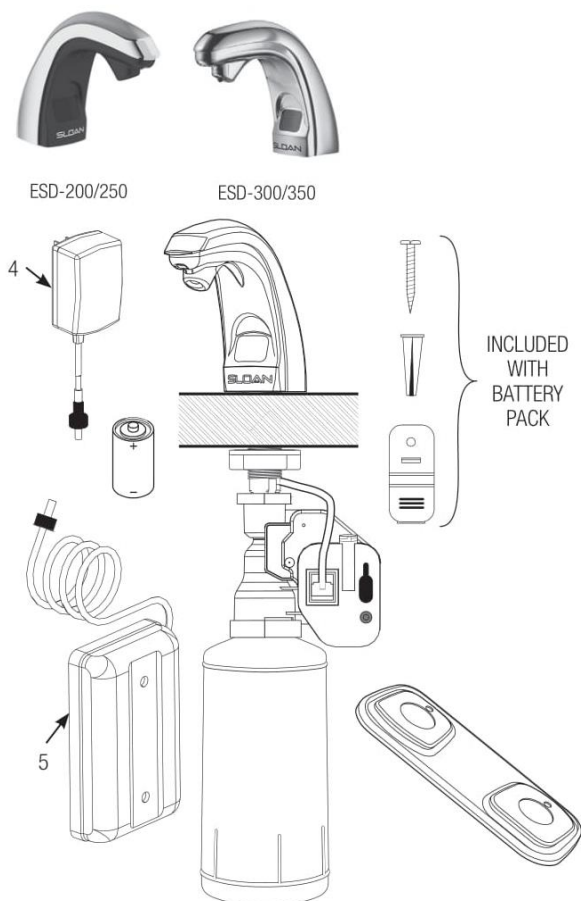
ESD-200/250 Series Soap Dispensers**ESD-300/350 Series Soap Dispensers**

Item No.	Part No.	Description
1A	ESD-216-A	Spout Assembly (Models ESD-200 & ESD-250)
1B	ESD-235-A	Spout Assembly (Models ESD-300 & ESD-350)
2	ESD-218	Mounting Hardware Kit (Includes items 2A and 2B)
2A	ESD-222	Rubber Gasket
2B	ESD-620	Flange Nut
3	ESD-209-A	Motor Assembly
4	ESD-227	Plug-in Transformer (Hardwire Models ESD-200 & ESD-300)
5	ESD-210	Battery Pack — Includes 4 D-size batteries, Screws and Anchors for Battery Compartment and Wall Clips for Power Cord (Battery Models ESD-250 & ESD-350)
6	ESD-217	Lotion Soap Refill Cartridge 800 ml (up to 1000 hand washes)
	ESD-232	Lotion Soap Refill Cartridge 1600 ml (up to 2000 hand washes)
	ESD-231	Anti-bacterial Soap Refill Cartridge 800 ml (up to 1000 hand washes)
	ESD-233	Anti-bacterial Refill Cartridge 1600 ml (up to 2000 hand washes)
7	ESD-223	D-size Alkaline Batteries (4 required) (Models ESD-250 & ESD-350)
8	ETF-299-A	Trim Plate for ESD-20080, ESD-25085, ESD-30880 & ESD-35187 Combination Soap Dispenser and Faucet

When the Soap Bottle is empty, a new Bottle must be used. The Bottle furnished with the unit is not designed to be refilled. Altering the Bottle and refilling it with soap will void the warranty of the product.

- ESD-233 — 1600 ml. bottle of Anti-bacterial Soap
- Can also be replaced with TC® OneShot® Soap Bottles listed in chart.

Refills are available through your local plumbing or janitorial supply distributor.

Soap Refill Cartridges Available:

- ESD-217 — 800 ml. bottle of Lotion Soap
- ESD-232 — 1600 ml. bottle of Lotion Soap
- ESD-231 — 800 ml. bottle of Anti-bacterial Soap

Red LED light is flashing.

- Refill bottle is low. Check the fill level and change as needed.
- Reset button was not pressed after the refill was installed. Press and release reset button.
- If reset button is held down more than one second, the red light will stay on. To turn the red light off, press the reset button quickly and the red light will go off.

• Yellow LED light is flashing (Models ESD-250 & ESD-350 only).

- Batteries are low. Replace with four (4) new D-size alkaline batteries.

• Preventing soap from dispensing while cleaning.

- Place your finger over the upper right hand or left hand corner of the sensor lens.

• The dispenser does not activate properly when hand is placed under spout.

- In rest rooms with fluorescent lighting, lighting that may be dying out or not burning at full intensity will cause interference with soap dispenser. Replace fluorescent tube(s) and soap dispenser will then function normally. Cool, white tubes are recommended.

5. Soap does not dispense when user “waves” their hands under the spout.

- Hands must be held “steady” under the spout for the dispenser to work.

6. Dispenser rotates due to users moving the spout.

- Tighten the existing flange nut on the shaft of the spout under the counter.
- If this problem continues, you can order a second “flange nut” (ESD-620) from Sloan Valve.

7. Soap does not dispense.

- Check that your power source is plugged in correctly.
- Make sure that batteries have been installed properly (Models ESD-250 & ESD-350 only).
- Make sure the pump is open on the refill bottle (see Step 5).

8. Tube pulls out of the refill bottle.

- The tubes have been “stitched” to prevent their removal, however please ensure that your housekeeping staff does not pick the bottle up or carry it by the tube.

SOAP DISPENSER ROUGH-IN

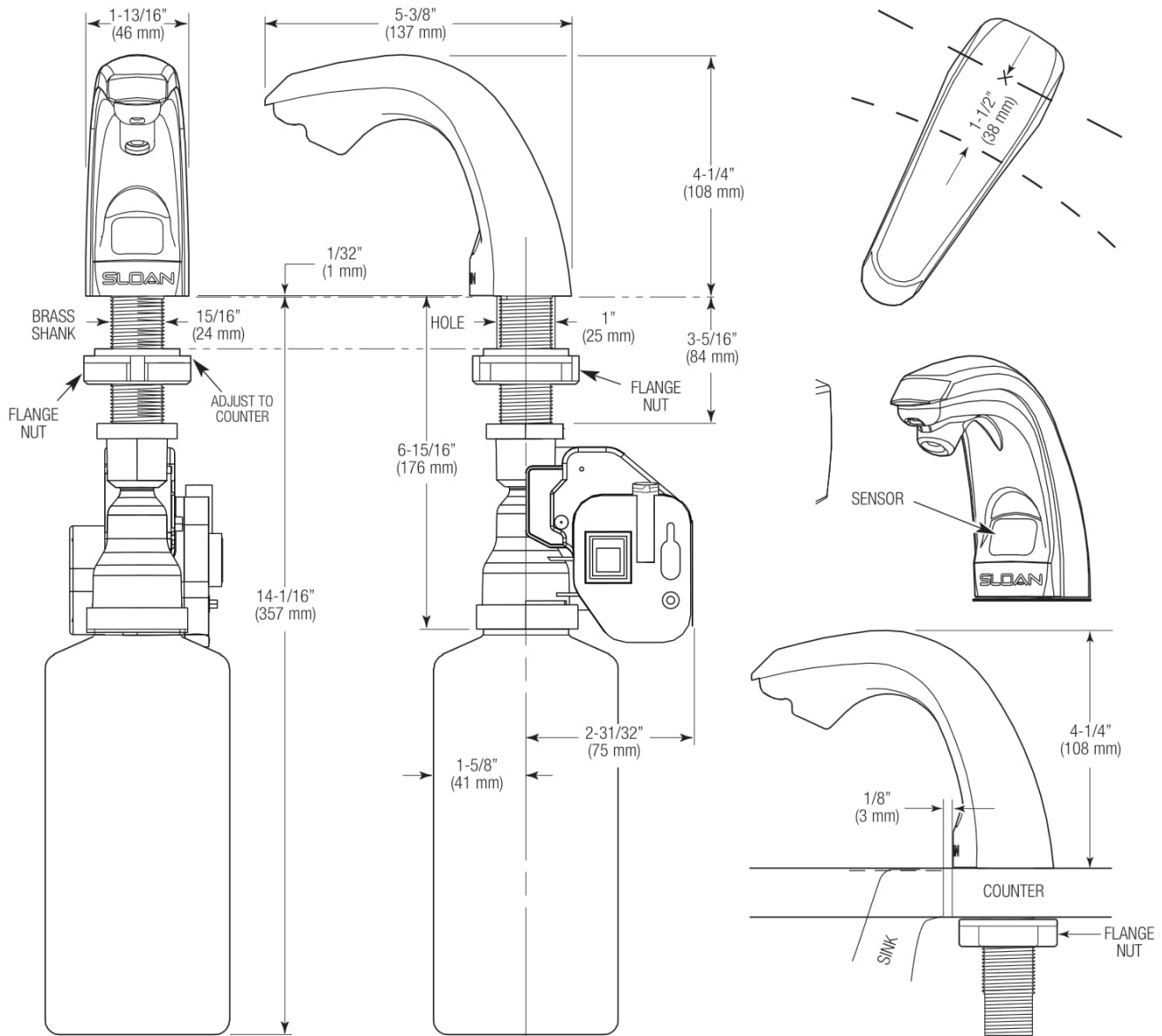

INSTALLATION

The ESD-200/250/300/350 Soap Dispenser oftentimes can be mounted in the left or right hole of a 4" or 8" center-set sink. The ability to do this is contingent upon the width of the faucet spout and accessibility to the unit on the underside of the sink (the Motor and Soap Bottle cannot interfere with the water or drain lines). When such interference above or below the sink occurs, the Soap Dispenser must be installed through the countertop to the side of the sink as shown.

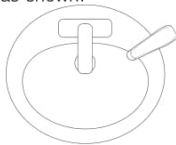

Model ESD-20080/25085/30880/35187 Soap Dispenser and Faucet Combinations

When the ESD Soap Dispenser is packaged with a Sloan ETF-80, ETF-880, EBF-85 or EBF-187 Faucet for installation on a 4" centerset sink, a special Trim Plate (ETF-299-A) is supplied. For these models, the Faucet must install on the left side and the Soap Dispenser on the right.

When installing the ESD-20080/25085/30880/35187, use these instructions in conjunction with the Installation Instructions packaged with the faucet.

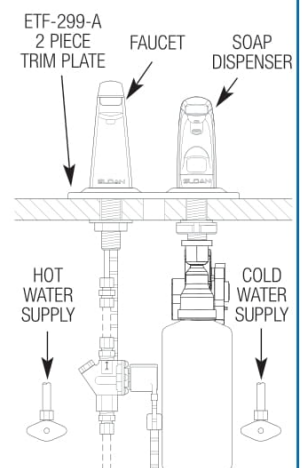

ESD-200, ESD-250, ESD-300 & ESD-350 Soap Dispenser Location Template

IMPORTANT: READ THIS BEFORE USING TEMPLATE.

If this Installation Instructions was printed from a PDF file to a computer printer, make certain that the template is the correct size before using. Measure to make certain that the 1-1/2" (38 mm) dimension shown on this template is correct. If the dimension measures less than 1-1/2" (38 mm), do one of the following:

- Reprint this template page making certain that all references to "Shrinking oversized pages to paper size" or "Fit to page" are unchecked in the Print window. Also, click the Printer Properties button (if available), and do the same. This template should then print to the proper size.
- Use this template as an example only for Soap Dispenser positioning.

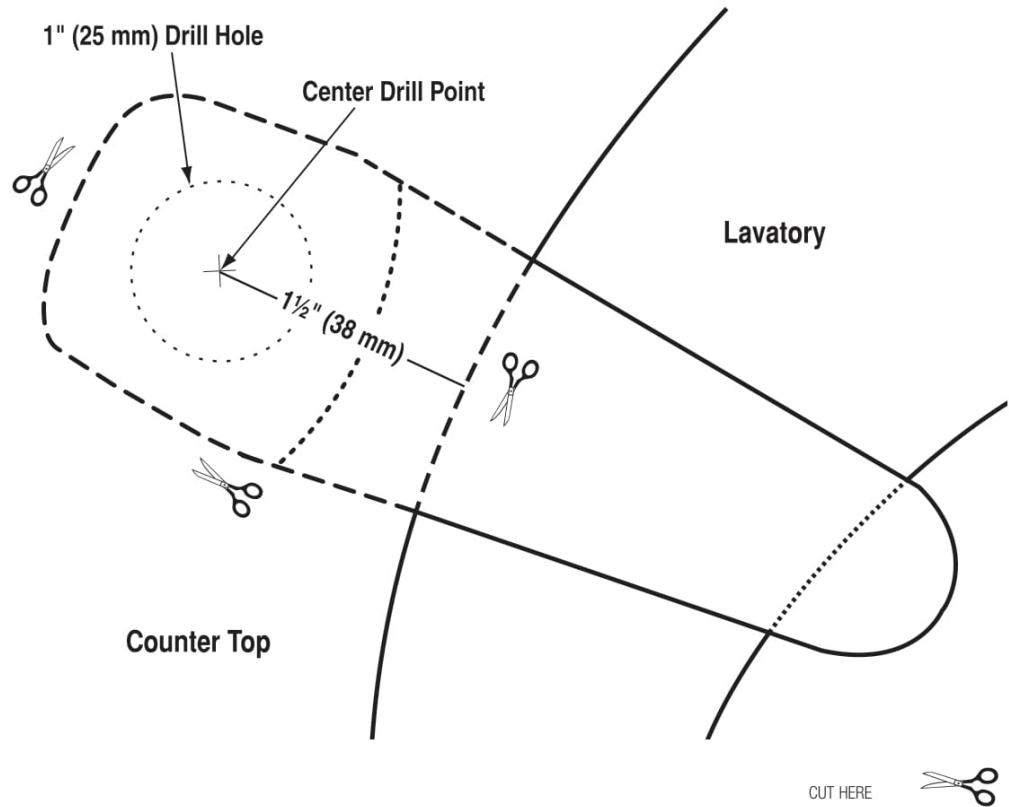

Soap Dispenser Mounted on Side of Sink

ESD-20080/25085/30880/35187 Soap Dispenser/Faucet Combination Shown on a 4" Centerset Sink

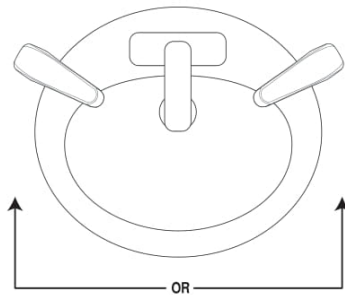

or

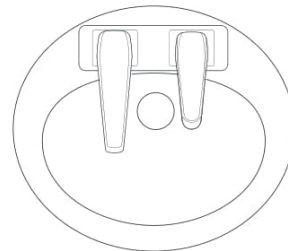

Ensure Soap System does not interfere with sink and plumbing under the counter

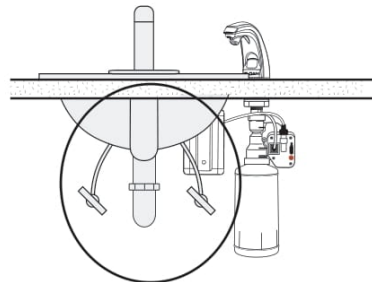
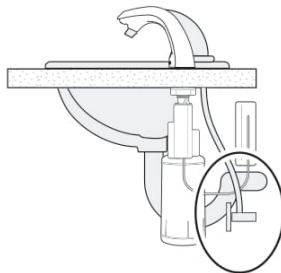

1 - Install Spout

- A** Slide Rubber Gasket onto Brass Shank making certain that hole in Gasket is positioned over Spring Pin in Base of Spout (where applicable).
- B** Guide Brass Shank and Sensor Cord through hole in counter.
- C** Position Spout to direct soap into sink.
- D** Guide Sensor Cord through Flange Nut. Screw Flange Nut onto Brass Shank and tighten.

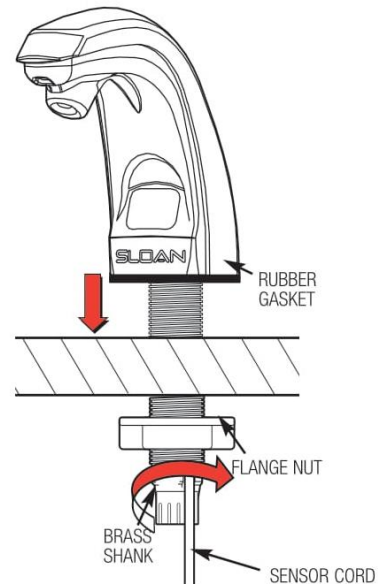

2 - Attach Motor Assembly

- A** Slide C-clip to open position.

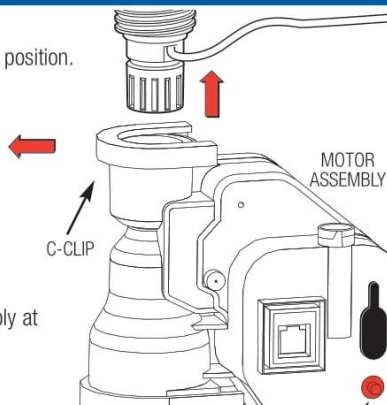

- B** Place motor assembly at bottom of shank.

- C** Rotate motor housing to avoid lavatory bottom and existing plumbing. Position motor housing so red reset button is accessible.

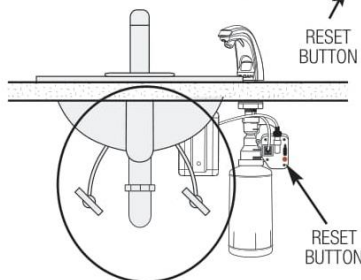

- D** Push the motor assembly up into place and secure by pushing the C-clip closed.

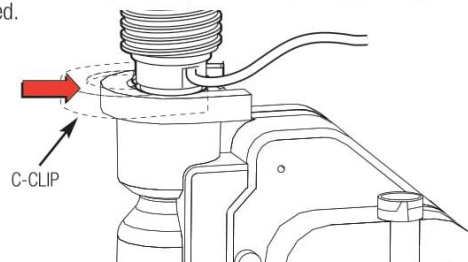

- E** Plug sensor connector into motor assembly and slide rubber seal into place.

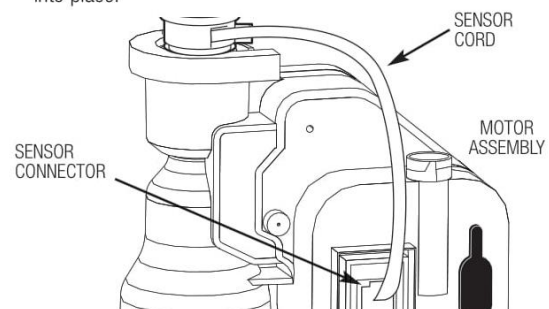

3 - Attach Battery Pack (Models ESD-250 & ESD-350 Only)

- A** Place battery pack in a convenient location ensuring easy access.

- B** Secure to wall with screws and anchors.

Note: The battery pack may be mounted using one screw and anchor with the top slot facilitating easy removal for battery replacement. A foam gasket is applied to the back to seal screw holes.

- C** Install 4 alkaline D-size batteries.

BATTERY PACK (CUTAWAY VIEW)

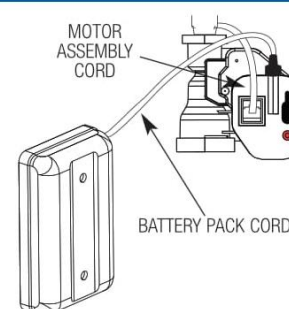
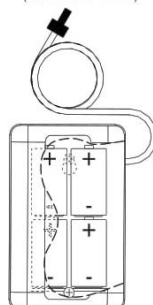

- D** Connect the power cord from the battery pack by inserting then screwing clockwise into inlet on top of motor assembly.

- E** Wall clip set may be used to hold the power cord against the wall.

4 - Connect AC Power (Models ESD-200 & ESD-300 Only)

- A** Connect the power cord from the transformer by inserting then screwing clockwise into inlet on top of motor assembly.

Note: Transformer supplied with 24" (610 mm) cord.

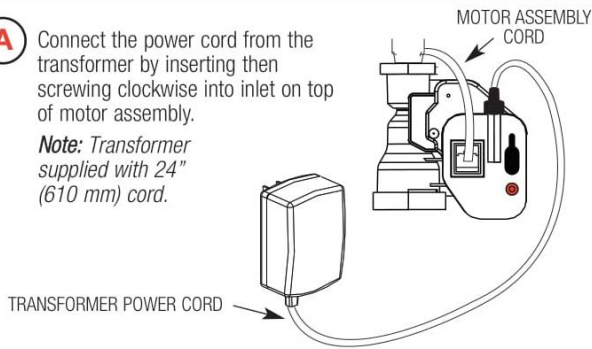

- B** Plug transformer into 120 VAC wall receptacle, activating the soap dispenser.

- C** Wall clip set may be used to hold the power cord against the wall.

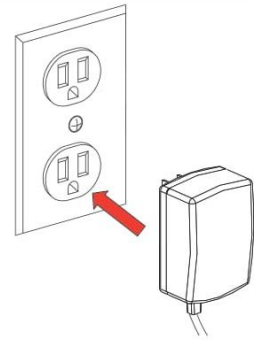

5 - Install Soap Cartridge

Important: DO NOT handle soap refill cartridge by tube. For proper operation, ensure that tubing is not loose or bent.

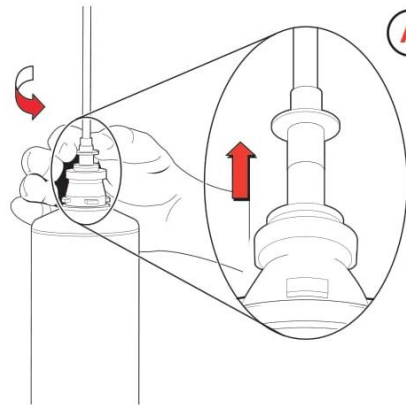

- A** Unlock pump on refill cartridge by twisting counter-clockwise. Actuator will pop-up.

- B** Guide refill tube up through bottom of motor assembly.

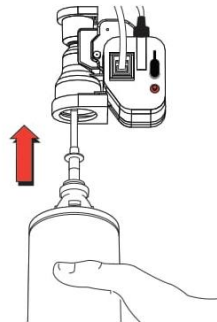

- C** Lock soap refill into place by turning clockwise ¼ turn.

- D** Press the refill reset button. This will automatically prime the soap refill bottle and initiate the counting mechanism.

800 ml. refill cartridge dispenses up to 1000 hand washes (supplied).

1600 ml. refill cartridge dispenses up to 2000 hand washes.

When using a 1600 ml. refill cartridge, the dipswitch (located on the Motor behind the black grommet just above the Reset Button) must be in the Down Position.

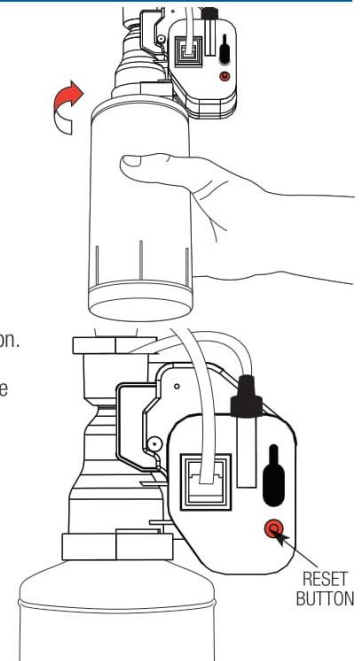

Operation

As the user's hands enter the beam's effective range, the beam is reflected back into the sensor receiver and activates the solenoid valve allowing a single soap application to flow from the spout.

- Flashing RED light in the sensor window indicates low refill.
- Flashing YELLOW light in the sensor window indicates low battery (Models ESD-250 & ESD-350 only).



CARE AND CLEANING OF...

...THE SOAP DISPENSER

Deactivate the soap dispenser by placing your fingers or thumb over the sensor area while you clean. The sensors are located in the upper right and upper left corners of the activation zone.

Once dispenser is cleaned, remove fingers or thumb from the sensor area.

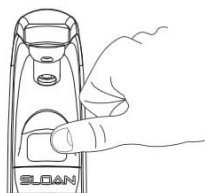

...CHROME AND SPECIAL FINISHES

DO NOT use abrasive or chemical cleaners (including chlorine bleach) to clean Spout that may dull the luster and attack the chrome or special decorative finishes. Use ONLY mild soap and water, then wipe dry with clean cloth or towel.

While cleaning the bathroom tile, protect the Spout from any splattering of cleaner. Acids and cleaning fluids will discolor or remove chrome plating.



SOAP REPLACEMENT

When the Soap Bottle is empty, a new Bottle must be used. The Bottle furnished with the unit is not designed to be refilled. Altering the Bottle and refilling it with soap will void the warranty of the product.

Soap Refill Cartridges Available:

- ESD-217 — 800 ml. bottle of Lotion Soap
- ESD-232 — 1600 ml. bottle of Lotion Soap
- ESD-231 — 800 ml. bottle of Anti-bacterial Soap
- ESD-233 — 1600 ml. bottle of Anti-bacterial Soap

Can also be replaced with TC® OneShot® Soap Bottles listed in chart.

Description	Sloan® Part No.	TC® OneShot® Stock No.
800 ml. bottle of Lotion Soap	ESD-217	401311
1600 ml. bottle of Lotion Soap	ESD-232	401541
800 ml. bottle of Anti-bacterial Soap	ESD-231	401312
1600 ml. bottle of Anti-bacterial Soap	ESD-233	401542

ATTENTION: Do not handle by tube. For proper operation, ensure that tubing is not loose or bent.

TROUBLESHOOTING GUIDE

- Red LED light is flashing.**
 - Refill bottle is low. Check the fill level and change as needed.
 - Reset button was not pressed after the refill was installed. Press and release reset button.
 - If reset button is held down more than one second, the red light will stay on. To turn the red light off, press the reset button quickly and the red light will go off.
- Yellow LED light is flashing (Models ESD-250 & ESD-350 only).**
 - Batteries are low. Replace with four (4) new D-size alkaline batteries.
- Preventing soap from dispensing while cleaning.**
 - Place your finger over the upper right hand or left hand corner of the sensor lens.
- The dispenser does not activate properly when hand is placed under spout.**
 - In rest rooms with fluorescent lighting, lighting that may be dying out or not burning at full intensity will cause interference with soap dispenser. Replace fluorescent tube(s) and soap dispenser will then function normally. Cool, white tubes are recommended.
- Soap does not dispense when user "waves" their hands under the spout.**
 - Hands must be held "steady" under the spout for the dispenser to work.
- Dispenser rotates due to users moving the spout.**
 - Tighten the existing flange nut on the shaft of the spout under the counter.
 - If this problem continues, you can order a second "flange nut" (ESD-620) from Sloan Valve.
- Soap does not dispense.**
 - Check that your power source is plugged in correctly.
 - Make sure that batteries have been installed properly (Models ESD-250 & ESD-350 only).
 - Make sure the pump is open on the refill bottle (see Step 5).
- Tube pulls out of the refill bottle.**
 - The tubes have been "stitched" to prevent their removal, however please ensure that your housekeeping staff does not pick the bottle up or carry it by the tube.

PARTS LIST

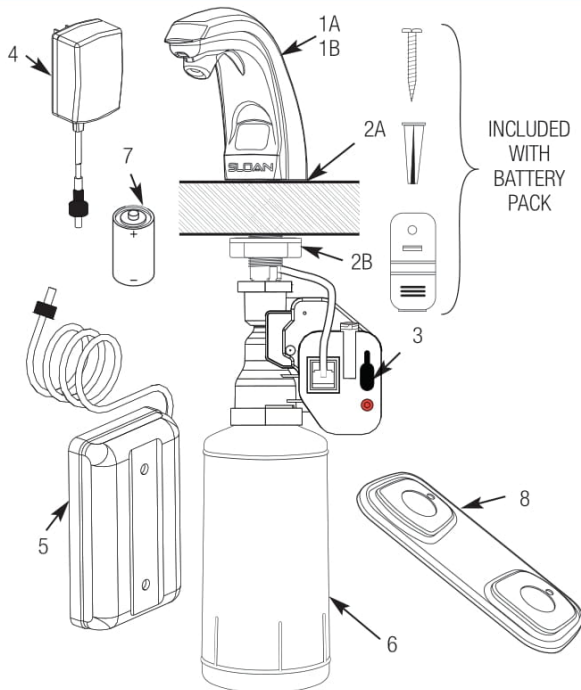

Item No.	Part No.	Description
1A	ESD-216-A	Spout Assembly (Models ESD-200 & ESD-250)
1B	ESD-235-A	Spout Assembly (Models ESD-300 & ESD-350)
2	ESD-218	Mounting Hardware Kit (Includes items 2A and 2B)
2A	ESD-222	Rubber Gasket
2B	ESD-620	Flange Nut
3	ESD-209-A	Motor Assembly
4	ESD-227	Plug-in Transformer (Models ESD-200 & ESD-300)
5	ESD-210	Battery Pack — Includes 4 D-size batteries, Screws and Anchors for Battery Compartment and Wall Clips for Power Cord (Models ESD-250 & ESD-350)
6	ESD-217	Lotion Soap Refill Cartridge 800 ml (up to 1000 hand washes)
	ESD-232	Lotion Soap Refill Cartridge 1600 ml (up to 2000 hand washes)
	ESD-231	Anti-bacterial Soap Refill Cartridge 800 ml (up to 1000 hand washes)
	ESD-233	Anti-bacterial Refill Cartridge 1600 ml (up to 2000 hand washes)
7	ESD-223	D-size Alkaline Batteries (4 required) (Models ESD-250 & ESD-350)
8	ETF-299-A	Trim Plate for ESD-20080, ESD-25085, ESD-30880 & ESD-35187 Combination Soap Dispenser and Faucet

The information contained in this document is subject to change without notice.